

L3525

MOTORIZED LINEAR STAGES

Technical Notes

The L3297 servo motion controller is a single-axis controller and amplifier designed for use with all servo motor stages. The controller can communicate with the host computer through an RS-232 or 10/100 Base-T Ethernet interface. With built-in high level functionality such as position tracking, contouring and teach/playback, programming the controller is greatly simplified.

The motion controller can operate as a stand-alone system through the digital I/O for synchronizing motion with external events. It utilises a 32-bit microprocessor

to control the trajectory profile, acceleration, velocity, deceleration and program memory with multi-tasking for simultaneously running up to eight programs.

Tips

Features:

Single-axis motion controller with on-board PWM drive for brush or brushless servo motor and integrated power supply. Ethernet 10/100 Base-T and (1) 19.2kb RS232 port.

Accepts encoder feedback up to 12 MHz. Advanced PID compensation with velocity and acceleration feedforward, integration

limits, notch filter and low-pass filter. Modes of motion include jogging, point-to-point positioning, contouring, electronic gearing and ECAM.

Multi-tasking for concurrent execution of up to eight application programs. Non-volatile memory for application programs, variables and arrays. Over 200 English-like commands executable by controller. Includes conditional statements and event triggers. Home input and forward and reverse limits. Four TTL uncommitted inputs and 4 outputs. TWO uncommitted analog inputs (0-5V).

Order No.	No. of axes	Input power	Drive current continuous Amps	Drive current peak Amps
L3525.SV1X	One	120-240V AC	7	10

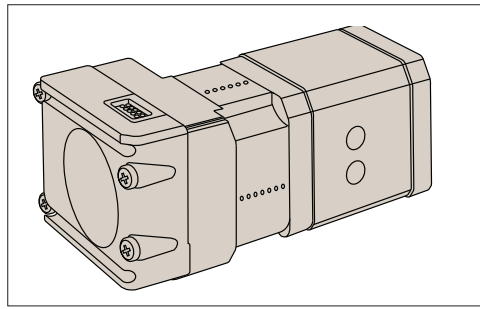

Intelligent stepper motor

- No need for separate motion controller.
- Inbuilt motor, driver and controller.

Options

- Standard
- With rotary encoder (512 line)

Separate motor controllers (single axis)

Single axis stepper controller



Single axis servo controller



Intelligent stepper motor

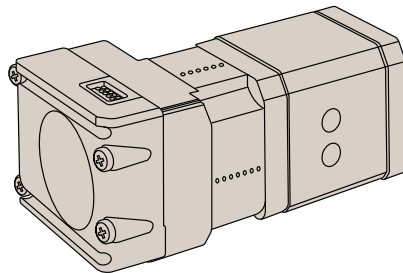

- Standard
- With rotary encoder (512 line)

Stepper motor

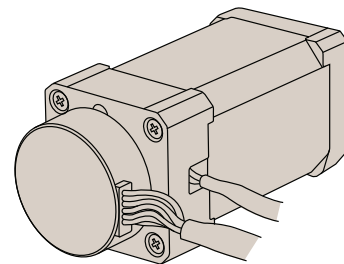

- Standard
- With rotary encoder (1000 line)

Servo motor

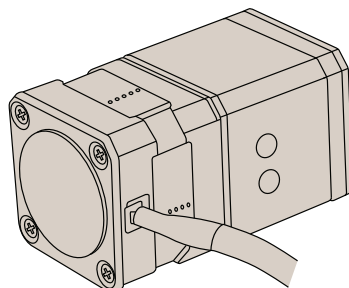

- Standard
- With rotary encoder (1000 line)

Positioning Stages from Automation Components

MOTORISED LINEAR STAGES

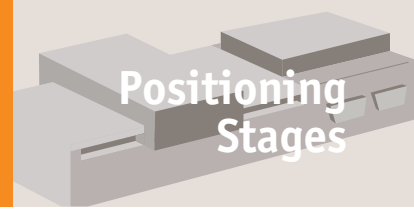

Controllers



L3294 Single axis stepper motor controller

- Communicate via RS-232 or Ethernet interface
- Uses virtually any programming language



L3295 Two axis stepper motor controller

- Communicate via RS-232 or Ethernet interface
- Programming via Labupu, VB, C++ and OSX etc.
- Stand alone programs can be downloaded
- Max output of 1.5A



L3296 Multi axis stepper motor controller

- Communicate via RS-232 or Ethernet interface
- Can control 4 axis and perform coordinated or independent motion of each or all the axis simultaneously
- Uses virtually any programming language



L3297 Single axis servo motor controller

- Communicate via RS-232 or Ethernet interface
- Uses virtually any programming language

Accessories



Joysticks



Digital readout



Connector RS232-USB

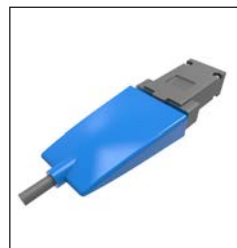

Connector RS422-USB

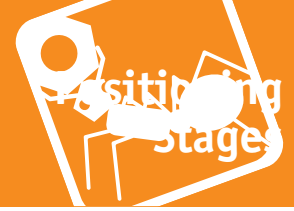

These have major benefits as they combine the motor (from size NEMA17 up) with an inbuilt driver and controller.

- Stepper or servo motor versions.
- Simple to install
- CE certified
- Free software programming

Plug and play

- Download free software
- Connect motor to computer (USB port)
- Connect power supply to the motor
- Start controlling/programming

- Low cost solution.
- The I/O points can be set by users to input, output or analogue input.
- NEMA17, 23, 34, 43 and larger sizes available.
- 12-48VDC.
- High torque stepper motors (1.2 to 10.5 Nm).
- Simple Windows software program provided free).
- Also Labview VB etc. programs.
- IP67, Motor brake.
- Optional Joysticks.