



Stainless Machine Mounts

polyurethane base



Levelling Feet

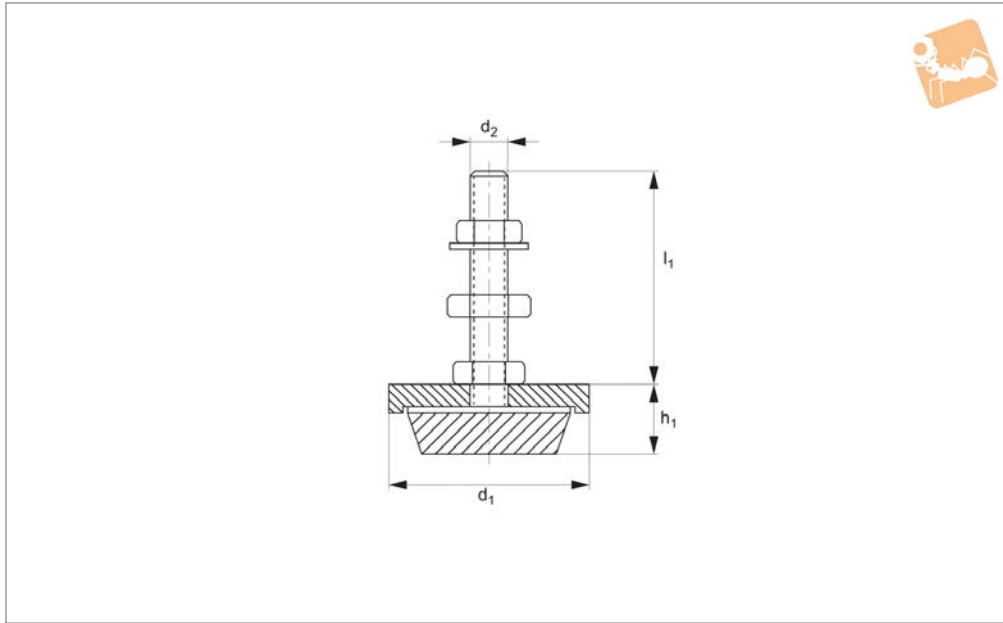

P2161

LEVELLING FEET

Material

Stainless steel body and thread (A2, AISI 304), with hard polyurethane base (80 Shore A).

applications. The hard polyurethane base is resistant to aggressive oils and chemicals.

Technical Notes

Ideally suited for food and pharmaceutical

Tips

The polyurethane base 80 Shore A also ensures very heavy load carrying capacity.

Order No.	d ₁	h ₁	d ₂	l ₁	Load range kgf
P2161.065	65	22	M12	90	200-800
P2161.100	100	30	M16	110	500-2000
P2161.120	120	33	M16	110	2000-4000
P2161.180	180	40	M16	110	4000-6000