

Stainless Clevis Joint

A4 stainless steel

Clevis Joints & Clips

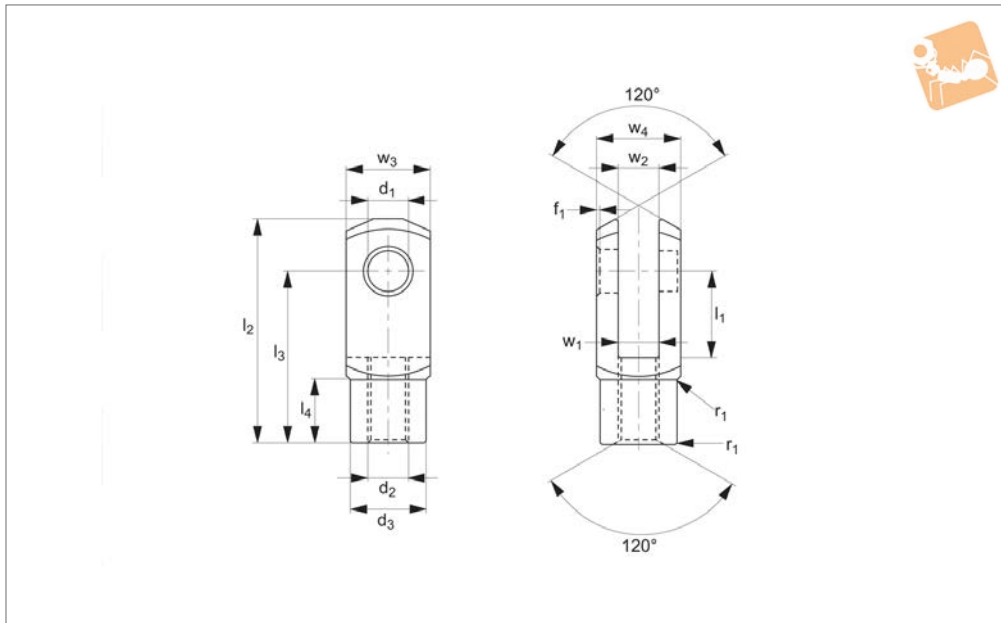

R3402.A4

CLEVIS JOINTS & CLIPS

Material

Stainless steel (1,4404, AISI 316).

Technical Notes

M4-M16: DIN 71 752/DIN ISO 8140.

M20: Similar to DIN 71 752 and according to CETOP standard.

Tips

Standard thread is right hand, (for left

hand, see R3403).

Important Notes

For sizes M4-M12, f and r = 0,5, for sizes M14-M16, f and r = 1, for size M20, f=1, r = 1,5

Other Tolerances:-

w₄: M4-M16 = +0,3 -0,16

M20 = +0,5 - 0,2

w₂: Size 4x8-10x20 = B13

Size 10x40-30x54 = +0,7 +0,15

l₃: up to size 6x12 = ±0,3

From size 6x24 = ±0,4

Order No.	Size	Thread hand	Thread type	d ₁ tol. h9	l ₁ ±0.5	d ₂	d ₃	l ₂ ±0.5	l ₃	l ₄	w ₁ ±0.5	w ₂	w ₃ tol. h11	w ₄	Weight g
R3402.R040-A4	4x8	Right	Coarse	4	8	M4	8	21	16	6.0	4	4	8	8	5
R3402.R051-A4	5x10	Right	Coarse	5	10	M5	9	26	20	7.5	5	5	10	10	9
R3402.R061-A4	6x12	Right	Coarse	6	12	M6	10	31	24	9.0	6	6	12	12	15
R3402.R081-A4	8x16	Right	Coarse	8	16	M8	14	42	32	12.0	8	8	16	16	37
R3402.R083-A4	8x32	Right	Coarse	8	32	M8	14	58	48	12.0	8	8	16	16	54
R3402.R102-A4	10x20	Right	Coarse	10	20	M10	18	52	40	15.0	10	10	20	20	74
R3402.R104-A4	10x40	Right	Coarse	10	40	M10	18	72	60	15.0	10	10	20	20	116
R3402.R122-A4	12x24	Right	Coarse	12	24	M12	20	62	48	18.0	12	12	24	24	121
R3402.R142-A4	14x28	Right	Coarse	14	28	M14	24	72	56	22.5	14	14	27	27	178
R3402.R163-A4	16x32	Right	Coarse	16	32	M16	26	83	64	24.0	16	16	32	32	282
R3402.R204-A4	20x40	Right	Coarse	20	40	M20	34	105	80	30.0	20	20	40	40	550