

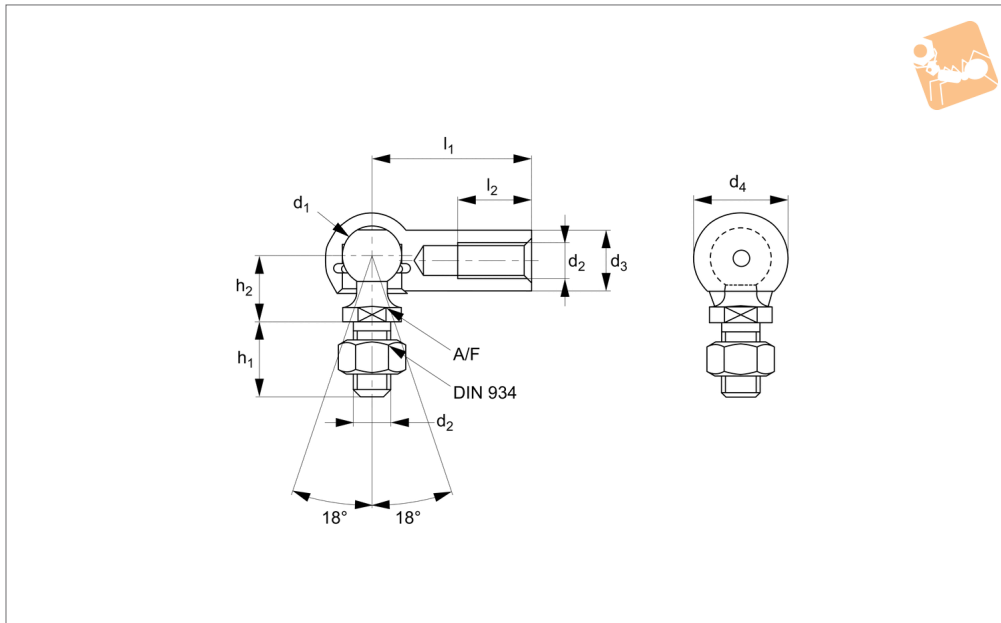

Ball and Socket Joints

with sealing cap - left hand thread

Ball & Socket Joints



R3471

BALL & SOCKET JOINTS

Material

Silver zinc plated, ball stud: minimum tensile strength $R_m=600N/mm^2$.
Housing: minimum tensile strength $R_m=500N/mm^2$, sealing cap: Neoprene.

hexagon nut.

Safety ring aids the retention of the ball stud in the housing.

*M14x1,5 is a fine pitch thread.

Important Notes

Thread is not full length. There is a min 1.5mm unthreaded shank. If using part without the supplied nut, then please consider a counterbore to accommodate the unthreaded shank.

Technical Notes

To DIN 71802 form CS, supplied with

Tips

Stud: right hand thread.

Housing: left hand thread

Order No.	Thread hand	d ₁	l ₁ ±0.3	d ₂	d ₃	d ₄	h ₁ ±0.3	Weight g
R3471.L005	Left	8	22	M 5	8	12.8	10.2	15.2
R3471.L006	Left	10	25	M 6	10	14.8	12.5	25.2
R3471.L008	Left	13	30	M 8	13	19.3	16.5	53.1
R3471.L010	Left	16	35	M10	16	24.0	20.0	103.8
R3471.L012	Left	16	35	M12	16	24.0	20.0	103.8
R3471.L014	Left	19	45	M14x1,5*	22	30.0	28.0	220.9
R3471.L015	Left	19	45	M14	22	30.0	28.0	220.9
R3471.L016	Left	19	45	M16	22	30.0	28.0	220.9

Order No.	h ₂ ±0.3	l ₂ min.	A/F tol. h14	Extraction force kg min.	Static load kg max.	Dyn. load C kg max.	Force required for movement kg max.
R3471.L005	9	10.2	7	3	50	20	3
R3471.L006	11	11.5	8	4	100	40	4
R3471.L008	13	14.0	11	6	200	80	6
R3471.L010	16	15.5	13	8	400	160	8
R3471.L012	16	15.5	13	8	400	160	8
R3471.L014	22	21.5	16	10	800	320	10
R3471.L015	22	21.5	16	10	800	320	10
R3471.L016	22	21.5	16	10	800	320	10