

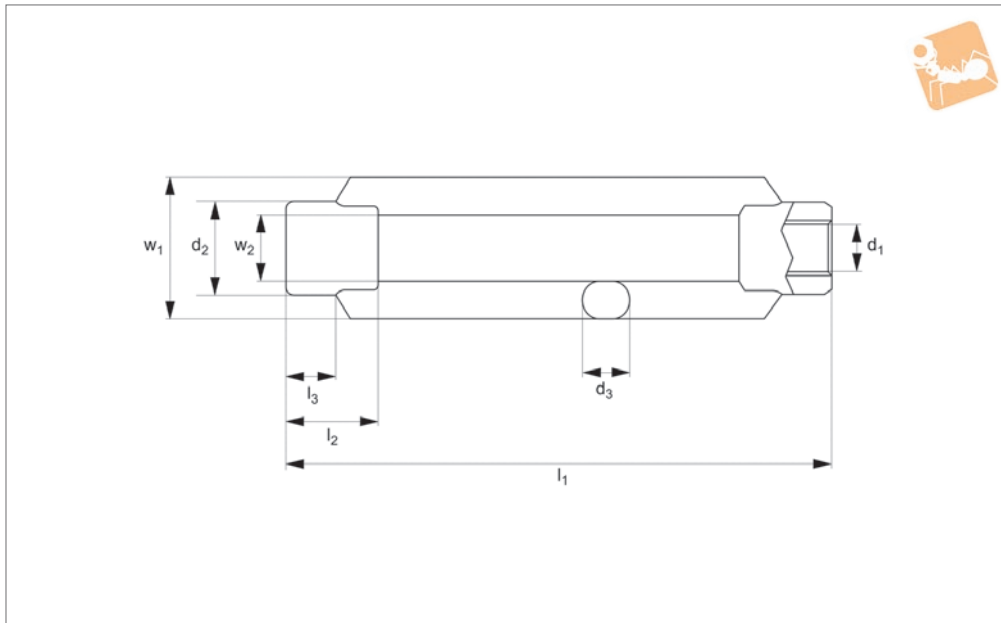

Turnbuckles steel

Turnbuckles

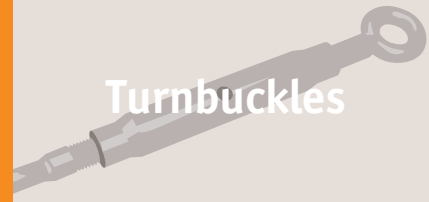

R3830

TURNBUCKLES

Material

Steel (1.0037), zinc-plated.
Hot dip galvanized, available on request providing increased protection against corrosion.

Tips

Turnbuckles consist of a metal frame with right hand thread one end and left hand thread the other end. Used for tensioning by rotating turnbuckle body without twisting attached rope or cable.

Important Notes

Turnbuckles are not to be used for lifting. Only suitable for use in tension.

Technical Notes

To DIN 1480.

Order No.	d ₁	l ₁	l ₂	l ₃	d ₂	d ₃	w ₁	w ₂	Adjustment	Weight kg
R3830.006-ZP	M 6	110	12	6	12	6	19	9	80	0.06
R3830.008-ZP	M 8	110	15	8	15	8	23	11	75	0.09
R3830.010-ZP	M10	125	18	9	18	9	30	14	85	0.15
R3830.012-ZP	M12	125	21	11	21	11	34	16	80	0.20
R3830.016-ZP	M16	170	27	14	27	14	42	20	110	0.44
R3830.020-ZP	M20	200	34	17	34	17	52	24	130	0.44
R3830.024-ZP	M24	255	39	20	39	20	60	28	170	1.20
R3830.030-ZP	M30	255	45	23	45	23	74	34	160	1.80
R3830.036-ZP	M36	295	55	28	55	28	86	40	180	3.20
R3830.042-ZP	M42	330	63	32	63	32	104	50	200	4.50
R3830.048-ZP	M48	355	78	39	80	40	135	65	195	9.10
R3830.056-ZP	M56	355	78	39	80	40	135	65	195	8.00