

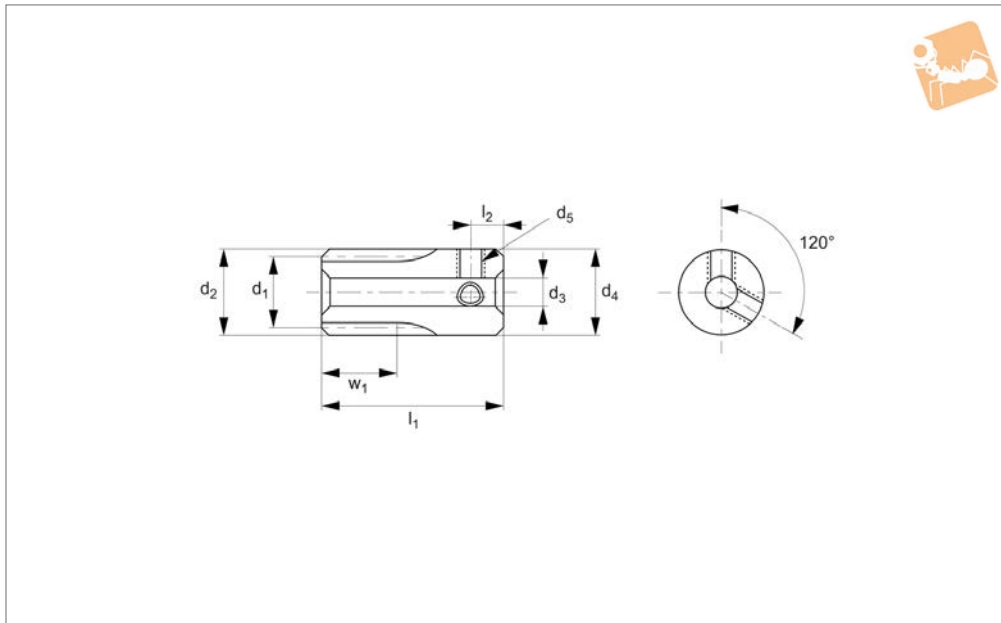

Spur Gears - Module 0.5 - Plastic

white - set screw - 14-18 teeth



R5112

STANDARD SPUR GEARS

Material

White polyacetal, machined. Accuracy to JIS B 1702-1 (ISO) class 9-10. Steel set screw.

Technical Notes

20° pressure angle, full depth tooth.

Amount of backlash when assembling gears = 0,01 - 0,03mm.

Tips

Module 0.5 for gears with 20-120 teeth see R5113. Max. allowable torque (Nm) is based on standard operating conditions

(see technical pages) with a safety factor of 1.2. For non standard applications apply a suitable safety factor depending on frequency of use, type of working etc.

Order No.	Module	No. of teeth z	Pitch dia. d ₁	d ₂	w ₁	d ₃ tol. H9	d ₄	l ₁	l ₃	Thread d ₅	Torque Nm max.	Weight g
R5112.050-014	m 0.5	14	7.0	8.0	8	3	9	18	3	2xM 3	0.214	1.15
R5112.050-015	m 0.5	15	7.5	8.5	8	3	9	18	3	2xM 3	0.229	1.22
R5112.050-016	m 0.5	16	8.0	9.0	8	3	9	18	3	2xM 3	0.244	1.29
R5112.050-018	m 0.5	18	9.0	10.0	8	3	10	18	3	2xM 3	0.275	1.65