

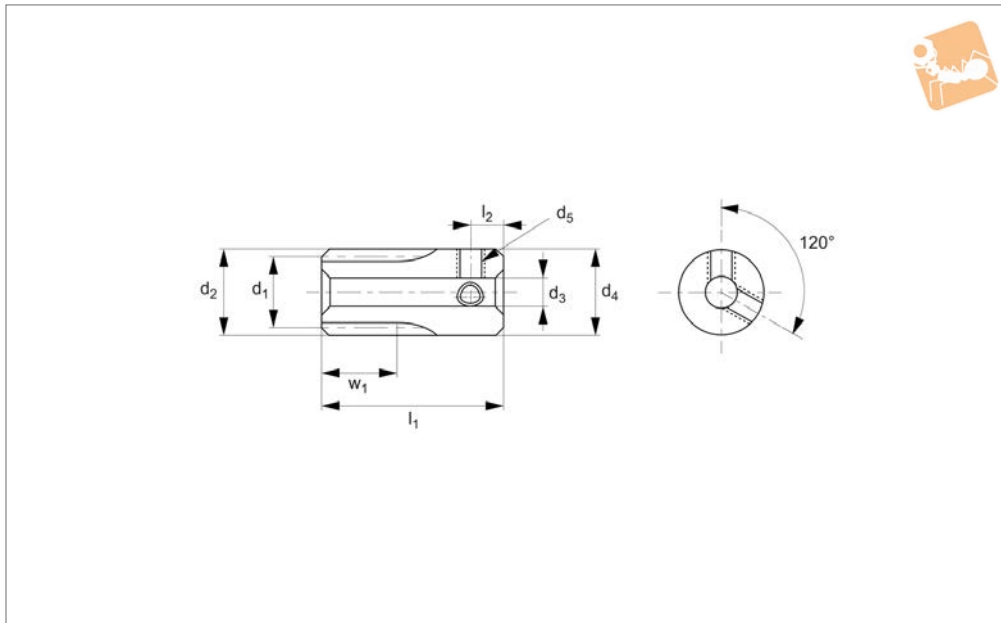

Spur Gears - Module 0.5 - Steel

carbon steel - 15-24 teeth



R5123

STANDARD SPUR GEARS

Material

Carbon steel (ISO C45). Accuracy to JIS B 1702-1 (ISO) class 8- 9.

Technical Notes

20° pressure angle, full depth tooth.
Amount of backlash when assembling

gears = 0,01 - 0,03mm.

Tips

For module 0.5 steel gears with 10-14 teeth, see R5121; for 25-120 teeth see R5125.
Max. allowable torque (Nm) is based on

standard operating conditions (see technical pages) with a safety factor of 1.2. For non standard applications apply a suitable safety factor depending on frequency of use, type of working etc.

Order No.	Module	No. of teeth z	Pitch dia. d ₁	d ₂	w ₁	d ₃ tol. H8	d ₄	l ₁	l ₂	Thread d ₅	Torque Nm max.	Weight g
R5123.050-015	m 0.5	15	7.5	8.5	8	3	8.5	18	3	2xM 3	0.95	6.0
R5123.050-016	m 0.5	16	8.0	9.0	8	3	9.0	18	3	2xM 3	1.05	6.9
R5123.050-018	m 0.5	18	9.0	10.0	8	4	10.0	18	3	2xM 3	1.26	8.1
R5123.050-020	m 0.5	20	10.0	11.0	8	4	11.0	18	3	2xM 3	1.48	10.3
R5123.050-021	m 0.5	21	10.5	11.5	8	4	11.5	18	3	2xM 3	1.59	11.5
R5123.050-022	m 0.5	22	11.0	12.0	8	4	12.0	18	3	2xM 3	1.71	12.7
R5123.050-024	m 0.5	24	12.0	13.0	8	4	13.0	18	3	2xM 3	1.93	15.4